

Version 1.02

(29.09.2014)

Installation instruction

FISTUNE® antenna module

Audi A6 Sedan 4G, Avant 4G

Article no. 39528
 39528-1
 39528-3



Contents

General advice	2
Safety instructions	3
References of legal regulations for operation	3
Installation instructions	4
Scope of delivery for 39528, 39528-1, 39528-3	4
Installation FISTUNE® Antennamodul A6 4G Sedan	5
Installation FISTUNE® Antennamodul A6 4G Avant – without TV from factory	6
Installation FISTUNE® Antennamodul A6 4G Avant – with TV from factory	8
Operation	8

General advice

While developing this product, your personal safety combined with the best operating service, modern design and an up-to-date production technique was especially taken into account.

Unfortunately, despite the utmost care injuries and/or damages might occur due to improper installation and/or use.

Therefore please read with great care and completely this operating manual and store it appropriately!

For your safety all our products pass through a 100% control check.

We reserve the right to carry out technical changes which serve the improvement at any time.

According to each article and purpose, it is sometimes necessary to check each country's legal regulations before installing and starting the unit.

In case of guarantee claims, the device has to be sent back to the seller in the original packaging with the attached bill of purchase and detailed defect's description. Please pay attention to the manufacturer's return requirements (RMA). The legal warranty directions are valid.

The warranty claims as well as the operating permissions become invalid due to:

- a) unauthorized changes to the device or accessories which have not been approved or carried out by the manufacturer or its partners*
- b) opening the device's frame*
- c) self-made repairs on the device*
- d) improper use / operation*
- e) brute force to the device (drop, willful damage, accident etc.)*

During installation, please pay attention to all safety relevant and legal directions.

The device has only to be installed by trained personnel or similarly qualified people.

Please limit the failure search to ca. 0,5 hour for the mechanical resp. 1.0 hour for electric labors during the assembly or functioning problems.

To avoid unnecessary additional expenses please send immediately an inquiry to our technical support using the Kufatec form (<http://www.kufatec.de/shop/de/infocenter/>).

Please provide always the following information:

- chassis number
- part number of the add-on kit
- exact description of the problem
- already executed labor

Safety instructions

The installation can be executed only by trained qualified personnel. Before the installation disconnect the power supply. Therefore cut off the battery from the vehicle electric system, follow the manufacturer's specification.

- *Never use bolts, screws and other fastening elements from car's safety devices or steering wheel, brakes because it may influence your driving safety and cause accidents.*
- *Connect the device only to a 12V vehicle voltage with chassis ground to the car body. This unit cannot be used in large trucks or other vehicles which use a DC 24 V battery wiring system voltage.*
- *Avoid to install the device in places where it could hinder the safe driving or functional efficiency of the other units installed in the vehicle.*
- *This unit is only for the use with the following vehicles and model line; Only connections described within this instruction manual are allowed or required to use for installation.*
- *For damage impact caused by faulty installation, unsuitable connections or assembling in inappropriate vehicle types or models Kufatec GmbH & Co.KG assumes no liability.*
- *We advise you that these units process data out of the MOST protocol from the vehicle. During the assembly of this unit we as supplier have access to a specific model and we as producer don't know the overall system you work with.*
- *Especially in case of changes within the same model line and the same model year we don't guarantee the usability of our products. In case of the usability of our products with the manufacturer's changes Kufatec GmbH assumes no liability.*
- *Kufatec GmbH assumes no liability that the assembly of the unit described in this manual is approved according the warranty regulations of the single car manufacturers. Please check your manufacturer's conditions and warranty before you begin the installation.*
- *Kufatec GmbH reserves the right to change the device specification without further notice.*
- *Errors and changes excepted.*

References of legal regulations for operation

Use this unit in the intended domain only.

If you use the unit in a foreign domain, if the unit is not installed properly, or if the unit will be reconstructed the operating permit and warranty will expire.

Installation instructions

The following presentation shows the laying of the wires and the position of the single components as well.

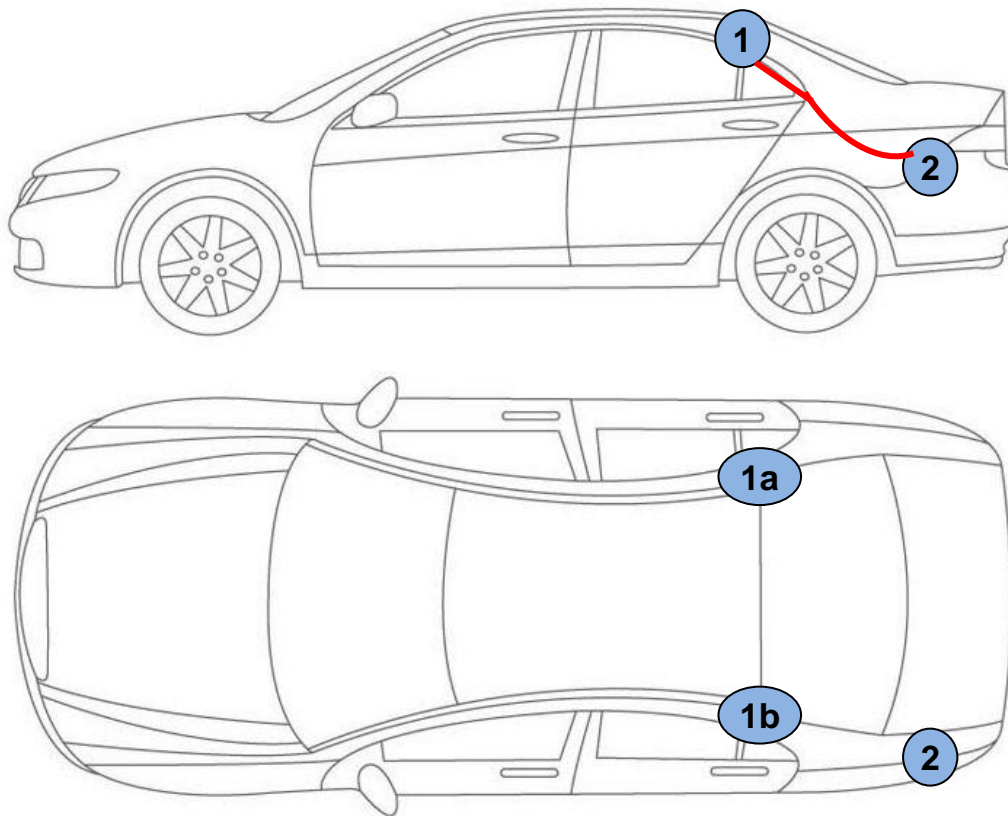

Scheme

1a – antenna module Sedan

1b – antenna module Avant

2 – FISTUNE® Interface

Scope of delivery for 39528, 39528-1, 39528-3

- FISTUNE® antenna module
- antenna wire

Installation FISTUNE® antenna modul A6 4G Sedan

At first, please remove the lining of the D- column at the passenger side, Fig. 1. Then solder the wires of the harness

black - at the top
blue - at the bottem

at the contacts of the rear window antenna, Fig. 2.

Note: Please make sure that the polarity is correct - black at the top and blue soldered at the bottem!



Fig. 1

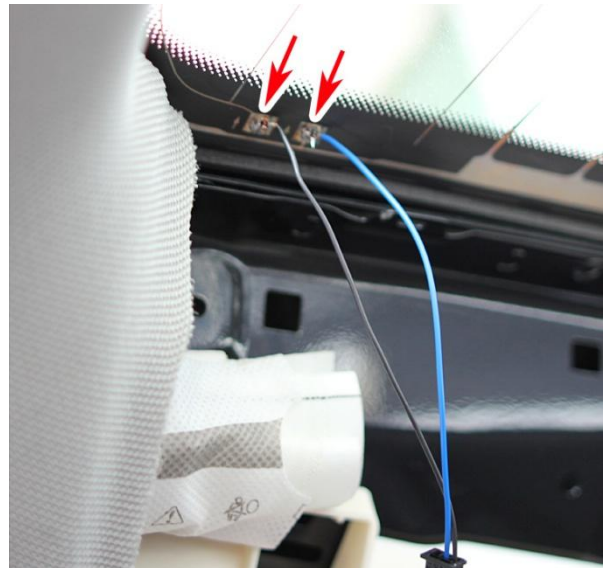

Fig. 2

Mount the antenna module with the screw as shown in Fig. 3 and connect it with the wires of the rear window antenna, Fig 3. Then lay the wires to the assembly position of the FISTUNE® module, Fig. 4.

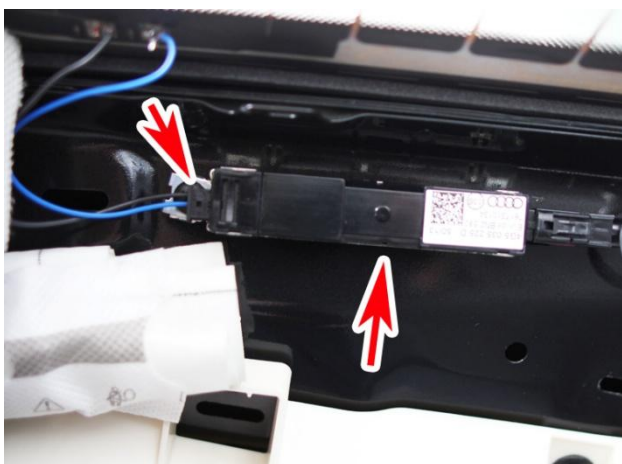

Fig. 3



Fig. 4

Installation FISTUNE® antenna modul A6 4G Avant – without TV from factory

The labors take place in the trunk starting with the disassembly of the roller blind /covering. This has to be hung out (fig 1). Then open the belt and the left trunk lining in order to reach the radio box situated behind (fig. 2).

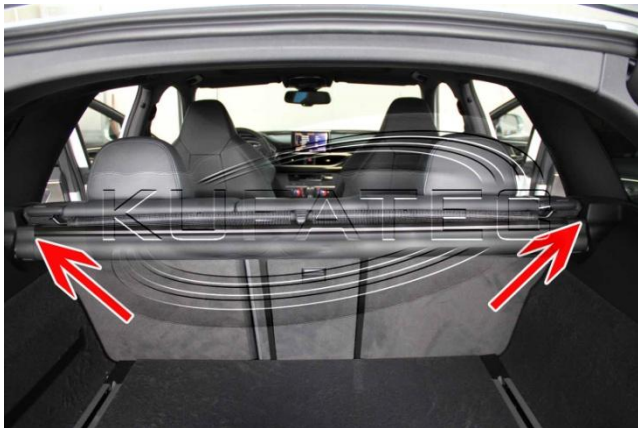

Fig. 1



Fig. 2

Now the lower rear bench seat (fig. 3) and the side cushion (fig 4) have to be removed respectively by simple hanging out and the upper rear bench seat is folded down by means of a lever (fig 5)).



Fig. 3



Fig. 4



Fig. 5

Then remove the screw (fig 6), in order to be able to pull forth the lining to the trunk and at the C-column, so the two contacts above in the C-column can be reached (fig. 7).



Fig. 6



Fig. 7

The cable is then soldered on the lower contact (fig 8). For this purpose prepare the solder surface by slight scratching. Then replace the existing antenna module for the delivered antenna module (fig. 9), plug everything in and pull the cable under the lining alongside up to the radio box by means of a pulling through facility (fig. 10).



Fig. 8



Fig. 9



Fig. 10

After the connection carry out sufficient functioning tests. If the tests are successful, so re-assemble everything in a backward sequence.

Intallation FISTUNE® Antennamodul A6 4G Avant – with TV from factory

Start with the removing of the rear left C-column lining. This is not fastened with any screw, but is latched only and can be easily pulled to the front.

Behind the lining there is the antenna module. Pull out all the plugs and remove the screw. Finally pull out the module.

Open the plastic casing of the FAKRA plug and insert the antenna wire in a free slot of the antenna module.

Plug in the new antenna module, fasten the screw, insert all the plugs back in place and then lay the antenna wire.

In case of an available factory-installed TV it is not necessary to solder, because an antenna module is already available.

NOTE The wires must not be coiled. In this way you create a reel and thereby possible failures.

Operation

Because the FISTUNE® is fully integrated in the vehicle therefore the operation of the digital radio reception takes place via your MMI.

The operation is explained in detail in the user guide of your vehicle (page 55 – 64).